

Remote control

>> Remote control top

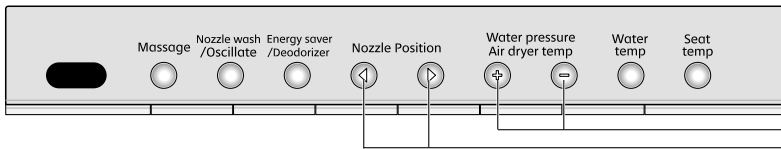

The water pressure and dryer temperature

The nozzle position can be adjusted

>> Remote control front

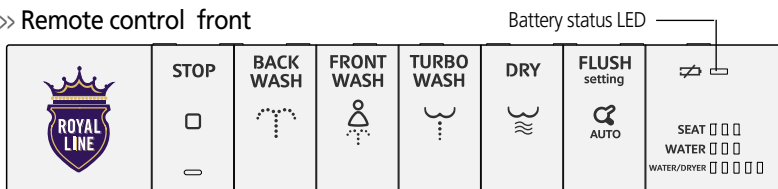

Manual Control



Manual flush
Front wash
Back wash
Stop

- Manual controls include manual flush, front wash, back wash, and stop buttons to use these functions quickly and easily.

- Manual flush button() can be used during power outages.

	Stop	Stop all operation	Massage	When selected during wash function, it starts massage wash. (To stop massage function, push the button one more time)
	Back wash	Back wash	Nozzle wash	Washes nozzle for 20 seconds
	Front wash	Front wash	Oscillate	When selected during wash function nozzle oscillates automatically for a wider wash. To stop oscillating function, push the button again.
	Turbo wash	Turbo wash	Energy saver	With automatic energy function, the seat temperature will stay at 89.6°F. If no one is using bidet, it returns to sleep mode. The automatic sleep mode can be adjusted by pressing energy safe button. (On/Off)
	DRY	Dry washed area	Deodorizer	After user stands up from the seat, it works approximately one more minute and automatically turns off. When the dryer function is selected, deodorization stops.
	Flush	Flush the toilet	Water temp	The water temperature can be adjusted up to 4 levels (off, low, middle, high) and can be checked by LED light
	Setting	Push this button for 3 seconds to set Auto Flush Setting (On/Off)	Seat temp	The seat temperature can be adjusted up to 4 levels (off, low, middle, high) and can be checked by LED light

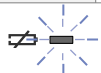

When Battery statue LED flashes, please change the battery.

Automatic self-cleaning nozzle function

- Without sitting on the seat, select automatic self-cleansing nozzle, and water flows automatically.
- Nozzle moves for about 20 seconds to wash entire nozzle and then automatically retracts.

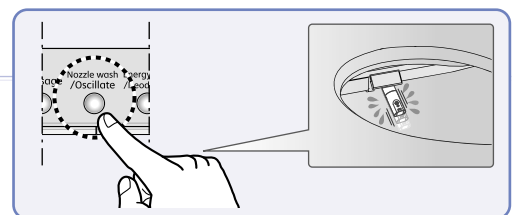

Initial setting for RF transmission remote control

- 1 Without sitting on the seat, push and hold stop and front wash button for 5 seconds on the simple control until the seat LED is turned on.
- 2 Push the stop button and seat button at the same time on the remote control for 10 seconds. Check that the seat LED is turned off with "beep" sound.
- 3 When the seat LED turns off, RF type remote control and main unit are synchronized.

